

Mie Prefecture **KUMANO KODO CENTER**

English



三重県立熊野古道センター

Introduction

About Kumano Kodo Center

The center commemorates the World Heritage listing of Kumano Kodo (Iseji) sacred sites and pilgrimage routes in the Kii Mountain Range. It was established by Mie Prefecture to inform visitors about Kumano Kodo and surrounding areas, mix with local people and in turn revitalize the region.

Role of Kumano Kodo Center

We collect, accumulate and provide information concerning the nature, history and culture of Kumano Kodo and surrounding areas on the theme of 'People and the path: here at, here in, and here after.' We also assist with exchanges between visitors to Kumano Kodo, welcoming parties and local people.

Activities of Kumano Kodo Center

To make good use of the architectural space, we developed activities unique to the center, such as exhibitions, workshops, courses and lectures, concerts, and events that give full play to Eastern Kishu's individual character. Furthermore, to promote exchanges, we are producing a wide variety of outdoor activities based around the center, such as a photography school, haiku traveling club and pilgrimage route walks.

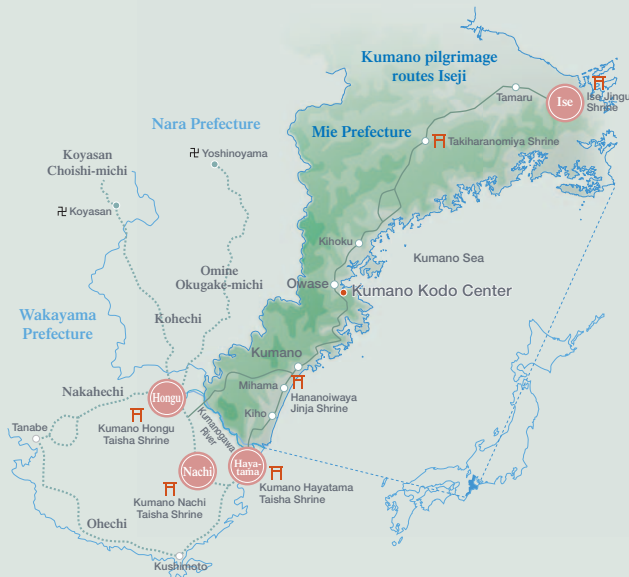

Sacred sites and pilgrimage routes in the Kii Mountain Range

Although there are differences in the origins and details of Shinto, which values the natural world, Buddhism, which was introduced from China, and mixtures of the two, such as Shugendo, the Kii Mountain Range embraces religious sites centered on the three sacred mountains of Kumano Sanzan, Yoshino–Omine and Koyasan. Together with the pilgrimage routes that lead to the sacred sites and are used for training in mountain austerities, these sites have played an important role in the development and exchange of Japanese religion and culture, and integrated people's religious beliefs and the natural environment since early times.

The sacred sites and pilgrimage routes in the Kii Mountain Range are World Heritage listed. They are recognized for the unique cultural landscape of the three great sacred sites and pilgrimage routes of Kumano Sankei-michi, Omine Okugake-michi and Koyasan Choishi-michi and others that extend across the three prefectures of Mie, Nara, and Wakayama. The sacred sites and pilgrimage routes in the Kii Mountain Range is the first cultural heritage recognized as a cultural landscape in its entirety in Japan.

World Heritage Listing

A condition to being listed as World Heritage is universal value worldwide. For this reason, it is necessary to meet one or more of the World Heritage criterion classified as cultural heritage and natural heritage, and satisfy the conditions of authenticity and integrity. The sacred sites and pilgrimage routes in the Kii Mountain Range meets four criterion out of the six cultural heritage criterion for World Heritage listing. This cultural heritage including monuments, sites and cultural landscapes, is preserved under unified efforts involving governments through local residents.

Construction



In constructing Kumano Kodo Center as a wooden building befitting of Kumano Kodo, we attempted to create a large space with a fine new wooden structural system. Using local Owase hinoki cypress and Kumano cedar lumber as sold in markets, the structure is composed of blocks of solid natural wood of the same cross-section (135 mm × 135 mm), without using a truss frame or laminated wood. Constructed of pillars, beams and walls made of bundled rectangular Owase hinoki cypress timber, the buildings show the simple beauty and strength of straight lines of wood while respecting decorous traditional Japanese building methods.



Exhibition

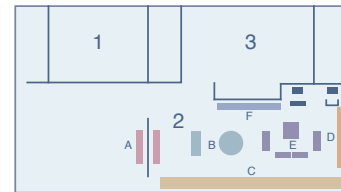

- 1 Video Room
- 2 Permanent Exhibition Room
 - A World Heritage Listing
 - B Aspects of Kumano Kodo
 - C Nature and life along Kumano Kodo
 - D Kumano pilgrimage and mandalas
 - E The people who walked the Kumano Kodo
 - F History of Kumano
- 3 Special Exhibition Gallery

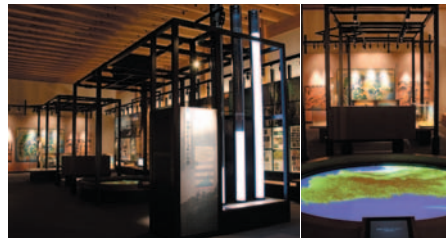

B. Aspects of Kumano Kodo

Through photos, models and so on, various aspects of the paths of Kumano including the climate around Kumano Kodo, which is warm with a high rainfall, the sea, sky and land are introduced.



E. The people who walked the Kumano Kodo

Six iconic scenes from the Iseji route on the Kumano Kodo depicting travelers and locals going about their work are described in miniature diorama. Original materials are also exhibited.



Multilingual audio guide (English, Chinese, Taiwanese, Korean and French)

Kumano Kodo Center has prepared a multilingual audio guide for use within the center. If you touch the sheet provided, there will be an easy-to-understand audio explanation about Kumano Kodo.

Center Information

Open	9:00 – 17:00 (admission until 16:30)
Closed	December 31 & January 1 (May be closed for maintenance at other times)
Entrance	Free of charge
Parking lot	Approx. 60 cars (disabled spaces available) / Free
Bicycle parking	Available

- Social Building**
- Social Building Foyer
 - Information Counter & Office
 - Meeting Room
 - Japanese-style Room
 - Hands-On Learning Room
- Exhibition Hall**
- Exhibition Hall Lobby
 - Permanent Exhibition Room
 - Special Exhibition Gallery
 - Video Room
- Research Collection Building**
- Reference Library
 - Special Display Room
 - Lawn Plaza
 - Car Arrivals & Rotary
 - Reserved Parking

Kumano Kodo Center Main Building

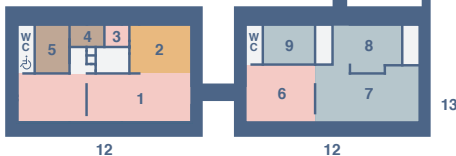

All buildings are barrier-free

Conditions of entry

- Smoking is prohibited inside the buildings. (Please smoke in the designated smoking area outdoors.)
- Please take your litter home with you.



By train Approx. 10 min. by bus or taxi from JR Owase station

From Nagoya | JR Limited Express Wideview Nanki (approx. 2 hr. and 40 min.) to Owase station

From Osaka | Kintetsu Limited Express (approx. 1 hr and 30 min.) to Matusaka station, transfer to JR Limited Express Wideview Nanki (approx. 1 hr and 20 min.) to Owase station

| JR Limited Express (approx. 4 hr.) to Shingu station, transfer to JR Limited Express Wideview Nanki (approx. 45 min.) to Owase station

By car

From Nagoya | Higashi-Meihan Expressway to Ise Expressway, change at Seiwa-Taki JCT to Kisei Expressway, approx. 10 min. from Owase Kita IC

From Osaka | Meishin Expressway to Shin-Meishin Expressway, change at Kameyama JCT for Higashi-Meihan Expressway to Ise Expressway, change at Seiwa-Taki JCT for Kisei Expressway, approx. 10 min. from Owase Kita IC

By bus

From Matusaka | Mie Kotsu Buses Nanki Limited Express (approx 2 hr. and 30 min.) to Kumano Kodo Center

Mie Prefecture KUMANO KODO CENTER

Mie Prefecture Designated Administrator: Kumano Kodo Nature, History and Culture Network, specified non-profit corporation
12-4 Mukai, Owase, Mie Prefecture 519-3625 Tel: 0597-25-2666 Fax: 0597-25-2667 E-mail: info@kumanokodocenter.com